



CONNEXION FIXE

CONNEXION VARIO



EN 795 type B: 2012
ANSI Z359.18
CSA Z259.15-17



Anchor strap
Sangle d'amarrage

WARNING / ATTENTION

Activities involving the use of this equipment are inherently dangerous. You are responsible for your own actions and decisions.

Before using this equipment, you must:
- Read and understand all Instructions for Use.
- Get specific training in its proper use.
- Become acquainted with its capabilities and limitations.
- Understand and accept the risks involved.



Les activités impliquant l'utilisation de cet équipement sont par nature dangereuses. Vous êtes responsable de vos actes, de vos décisions et de votre sécurité.

Avant d'utiliser cet équipement, vous devez :
- Lire et comprendre toutes les instructions d'utilisation.
- Vous former spécifiquement à l'utilisation de cet équipement.
- Vous familiariser avec votre équipement, apprendre à connaître ses performances et ses limites.
- Comprendre et accepter les risques induits.

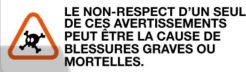

ANCHORAGE CONNECTOR
IN ACCORDANCE WITH ANSI/ASSP Z359.18 type A AND CSA Z259.15-17 class A

CONNECTEUR D'ANCRAGE
CONFORME À ANSI/ASSP Z359.18 type A ET CSA Z259.15-17 class A

1. Field of application (text part)
Champ d'application (partie texte)

2. Nomenclature
Nomenclature

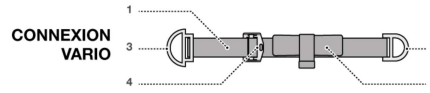
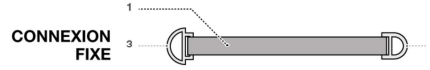

3. Inspection, points to verify
Contrôle, points à vérifier



PPE checking
Vérification EPI
PETZL.COM



Traceability and markings
Traçabilité et marquage

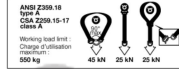
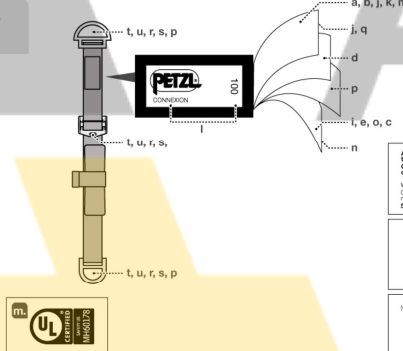
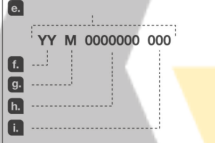

MEETS THE MULTIPLE CONFIGURATION STRAP REQUIREMENTS OF NFPA 1983, INCORPORATED IN THE 2002 EDITION OF NFPA 2500.
MINIMUM BREAKING STRENGTH AND RATING ARE DETERMINED USING A BASKET (B) CONFIGURATION. IN ADDITION, THIS STRAP HAS A MINIMUM BREAKING STRENGTH OF 25 kN IN A CHECKER CONFIGURATION 25 kN WHEN PULLED END TO END.



PETZL
ZI Cidex 105A
39500 Crozes
France
www.petzl.com/contact
Tel: +33 (0)4 76 92 09 00



PETZL
FR-38920 Crozes
Cidex 105A
PETZL.COM
ISO 9001 © Petzl
Tel: +33 (0)4 76 92 09 00
Made in France

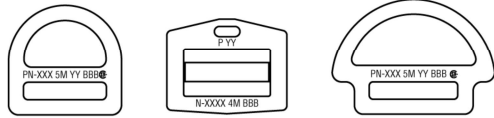

4. Compatibility (text part)
Compatibilité (partie texte)

5. Dimensions
Dimensions

• **CONNEXION FIXE**
G010AAXX

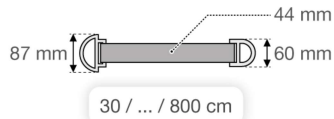

• **CONNEXION VARIO 30-200 cm**
G011AA00

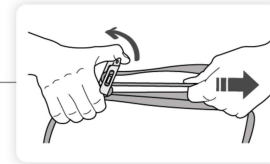
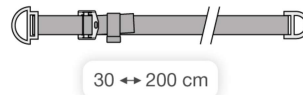

• **CONNEXION VARIO 200-400 cm**
G011AA00

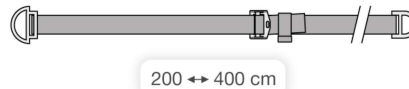

**NFPA CERTIFICATION FOR
CONNEXION FIXE - VARIO**

MEETS THE MULTIPLE CONFIGURATION STRAP REQUIREMENTS OF NFPA 1983, INCORPORATED IN THE 2022 EDITION OF NFPA 2500.

MINIMUM BREAKING STRENGTH AND RATING ARE DETERMINED USING A BASKET (U) CONFIGURATION. IN ADDITION, THIS STRAP HAS A MINIMUM BREAKING STRENGTH OF:
25 kN IN A CHOKER CONFIGURATION
25 kN WHEN PULLED END TO END.



**Multiple configuration strap
G (GENERAL USE)
MBS 45kN
MEETS NFPA 2500 (1983) - 2022**

Exposure of the strap to flame or high temperature beyond these limits could cause the strap to melt, burn and fail. Take care to protect the strap from such exposure during use, transport, storage, etc. Read this notice carefully and keep it in a permanent record for reference after it is removed from the strap. Any user of the strap should be provided with a copy of this notice for reference before and after each use.

Additional information regarding multiple configuration strap can be found in NFPA 1500 and NFPA 1858 and NFPA 1983, incorporated in the 2022 edition of NFPA 2500.

WORKING LOAD LIMIT: 550 kg

**CERTIFICATION NFPA POUR
CONNEXION FIXE - VARIO**

CONFORME AUX EXIGENCES DES ANCRAGES A CONFIGURATION MULTIPLE DE LA NFPA 1983, INCORPORATED IN THE 2022 EDITION OF NFPA 2500.

LES CHARGES DE RUPTURE MINIMUM SONT DETERMINEES EN CONFIGURATION BASKET (U); EN COMPLEMENT, CETTE SANGLE A UNE CHARGE DE RUPTURE MINIMUM DE :
25 kN EN CONFIGURATION ÉTRANGLEUSE
25 kN EN TRACTION DIRECTE.

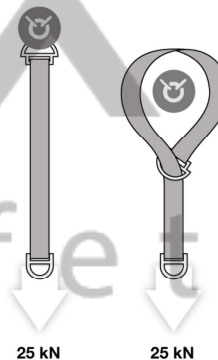

25 kN

25 kN



45 kN

Des informations complémentaires concernant les configurations avec plusieurs sangles sont disponibles dans la NFPA 1500, NFPA 1858 et NFPA 1983, incorporées dans l'édition 2022 de la norme NFPA 2500.

CHARGE D'UTILISATION MAXIMUM : 550 kg

6. Installation
Installation

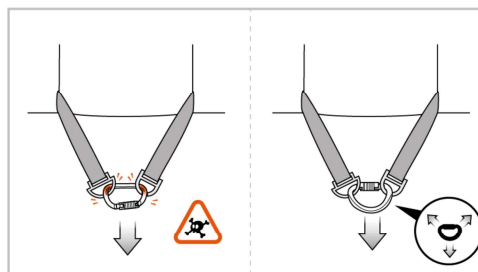
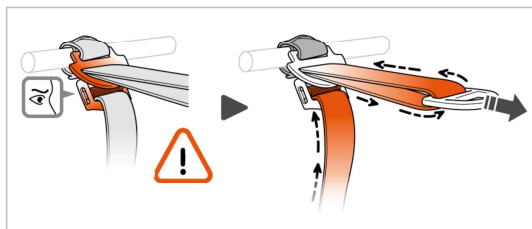
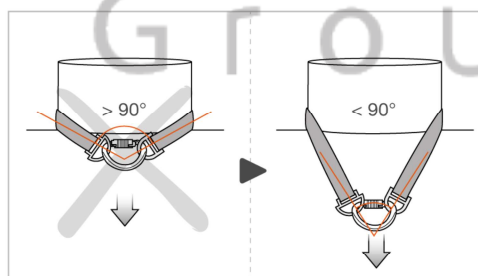
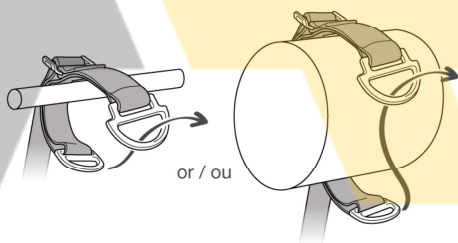
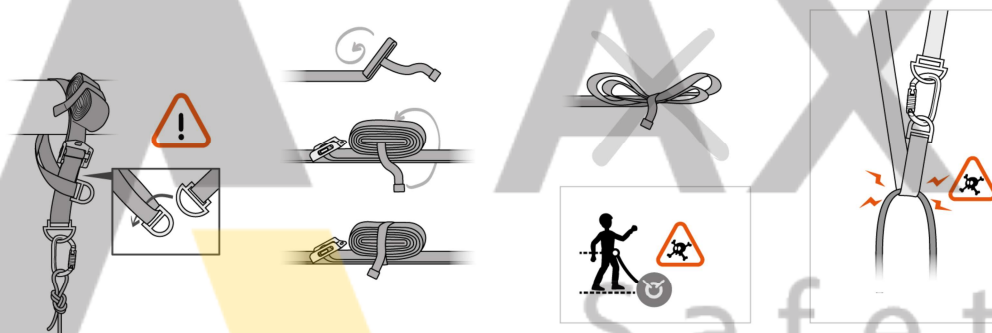
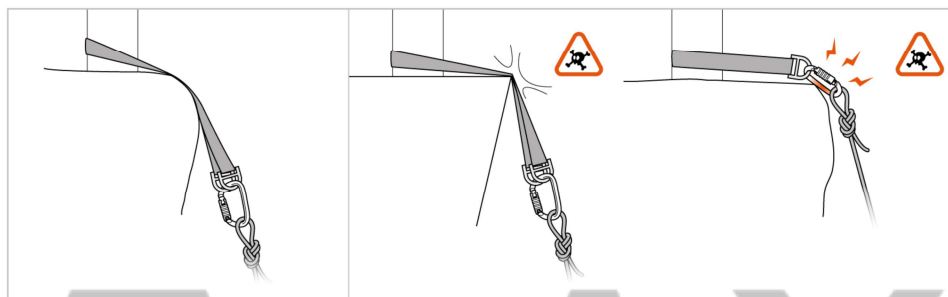
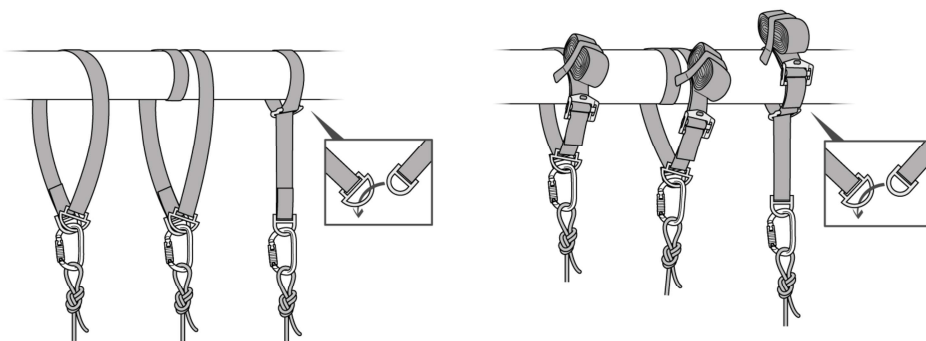

7. Additional information
Informations complémentaires

A. Lifetime / Durée de vie

Serial n° / n° de serie
XXXX XX XXXX + 10 years
ans

B. Markings
Marquage



C. Acceptable T°
T° tolérées

+ 50°C / + 122°F
- 30°C / - 22 °F

D. Precautions for use / Précautions d'usage



E. Cleaning - Disinfection / Nettoyage - Désinfection



F. Drying / Séchage



G. Storage - Transport
Stockage - transport



I. Modifications - Repairs
Modifications - Réparations



J. FAQ - Contact
Questions - Contact

